



**JAY R. SMITH MFG. CO.**  
 DIVISION OF SMITH INDUSTRIES, INC.  
 POST OFFICE BOX 3237  
 MONTGOMERY, ALABAMA 36109-0237 (USA)  
 TEL: 334-277-8520 FAX: 334-272-7396 www.jrsmith.com



MEMBER OF:



LOCATION

# SPECIAL PURPOSE DRAINS

## HEAVY DUTY ROADWAY DRAIN

**FUNCTION:** Used in roadways, parking and trucking areas to handle both heavy traffic loads and a large volume of surface water. Internal dome strainer protects the waste system from entrance of debris.

Free Area  
 47 SQ IN  
 (303) SQ CM

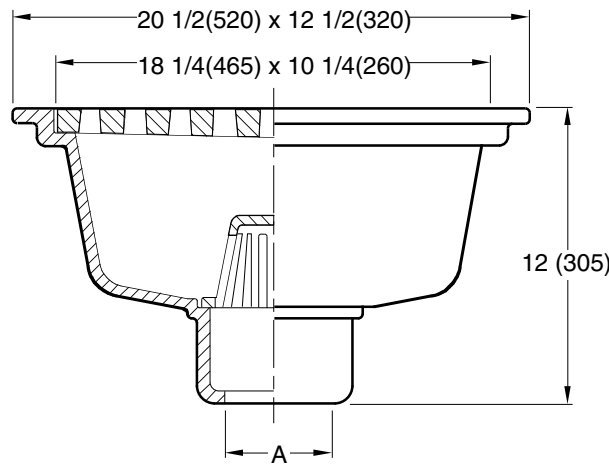

A (Pipe Size) = 03(50), 04(100), 05(125) or 06(150)

 Fig. 2570C ... CAULK OUTLET

**NOTE:** Dimensions shown in parentheses are in millimeters.

**REGULARLY FURNISHED:**  
 Duco Cast Iron Body with Loose Set Grate and Dome Bottom Strainer.

**VARIATIONS:**  
 Vandal Proof Grate -U

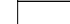
**OPTIONAL MATERIALS:**  
 Ductile Iron Grate -M  
 Galvanized Cast Iron -G

DRAWING NUMBER  
 S2570

SIZE  
 A

SCALE:  
 NONE

DATE:  
 5-17-85

APPROVED BY:  
 TD

CHECKED BY:  
 TD

DRAWN BY:  
 PJ

2570

WE CAN ASSUME NO RESPONSIBILITY FOR USE OF SUPERSEDED OR VOID DATA

FIGURE NUMBER

B  
 A

4-10-97  
 11-10-93

Added Millimeters  
 Submittal Update

EMB  
 EMB

BS  
 BS

WEIGHT  
 POUNDS

VOLUME  
 CUBIC FEET

FIGURE NUMBER

2570

REV.	DATE	DESCRIPTION	BY	CKD. BY