

FLOOR DRAINS
WITH HEAVY DUTY WIDE FLANGE FLASHING COLLAR

DRAWING NUMBER: **S2624**
 SIZE: **A**
 SCALE: **NONE**
 DATE: **5-6-93**
 APPROVED BY: **BS**
 CHECKED BY: **CR**
 DRAWN BY: **TBW**

WE CAN ASSUME NO RESPONSIBILITY FOR USE OF SUPERSEDED OR VOID DATA

Free Area
 45 SQ IN
 (290) SQ CM

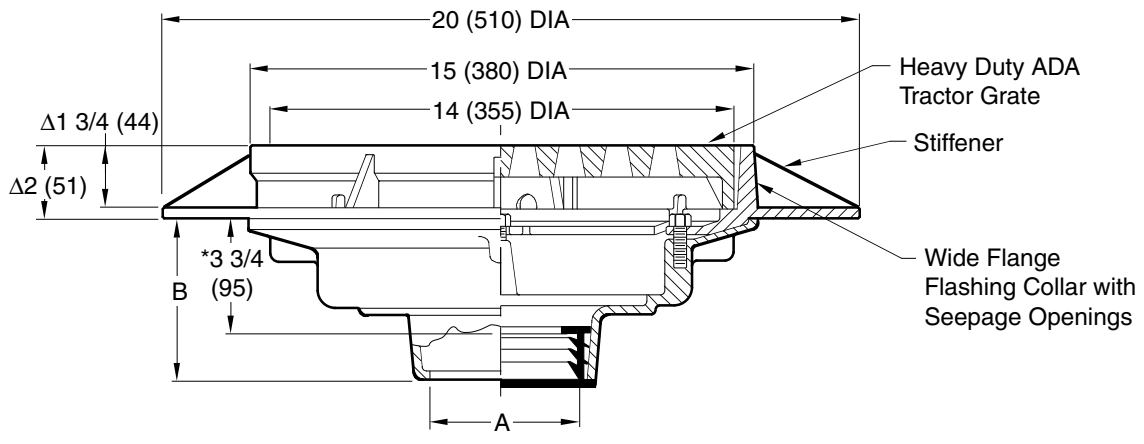

Fig. 2624C CAULK OUTLET
 Fig. 2624Y NO-HUB OUTLET

recommended deck opening - 16" (405) DIA
 *This dimension to internal stop of Speedi-Set gasket.
 Δ Add 1/4" (6) when bronze top is specified.

NOTE: Dimensions shown in parentheses are in millimeters.

A SIZE	02(50), 03(75), 04(100), 05(125), or 06(150)	08(200)
B	5 (125) for Caulk, NO-HUB and Speedi-Set. 3 3/4 (95) for Threaded	6 (150) for Caulk and NO-HUB 5 (125) for Threaded

REGULARLY FURNISHED:
 Duco Cast Iron Body, Heavy Duty Wide Flange Flashing Collar with Heavy Duty ADA Tractor Grate.

- VARIATIONS:**
- Dome Bottom Strainer -DBS
 - Cast Iron Flat Bottom Strainer -FBSCI
 - Side Outlet (Specify Fig. 2629)
 - Square Top -S
 - Vandal Proof -U
 - L Speedi-Set Service Weight
02(50), 03(75) & 04"(100) sizes only
 - LXH Speedi-Set Extra Heavy
02(50), 03(75) & 04"(100) sizes only
 - T Threaded Outlet

- OPTIONAL MATERIALS:**
- Ductile Iron Grate -M
 - Galvanized Cast Iron -G
 - Nickel Bronze Top -NB
 - Polished Bronze Top -PB

2624

FIGURE NUMBER	H G	11/18/10 5-20-04	Added ADA to Grate Rev. Table	JJ RN	CL	WEIGHT POUNDS	VOLUME CUBIC FEET	FIGURE NUMBER 2624
REV.	DATE	DESCRIPTION	BY	CKD. BY				