

C
 DRAWING NUMBER
 SSQ-8-1896
 SIZE
 A
 SCALE:
 NONE
 DATE:
 8-8-96
 APPROVED BY:
 CHECKED BY:
 DRAWN BY:
 CMD
 FIGURE NUMBER
 SQ-8-1896

SMITH® JAY R. SMITH MFG. CO.®
 DIVISION OF SMITH INDUSTRIES, INC.
 POST OFFICE BOX 3237
 MONTGOMERY, ALABAMA 36109-0237 (USA)
 TEL: 334-277-8520 FAX: 334-272-7396 www.jrsmith.com



LOCATION

GREASE INTERCEPTORS WITH ENCLOSED SEALED CRADLE

FUNCTION: The cradle is provided with pre-determined inlet and outlet locations to match the centerline dimension of the drainage (waste) piping. The cradle can be set in the slab at the time of the pouring or set in a pre-sleeved opening in a pre-cast slab. The interceptor unit is lowered into the cradle and connected to the drainage piping. The installer makes the final seal around the perimeter of the drainage piping passing through the cradle walls. The interceptor is readily accessible for cleaning and inspection by removing the cradle cover which sits flush with the floor and removing the interceptor cover. The cradle shall be supported by independent structural supports attached to the building structural system.

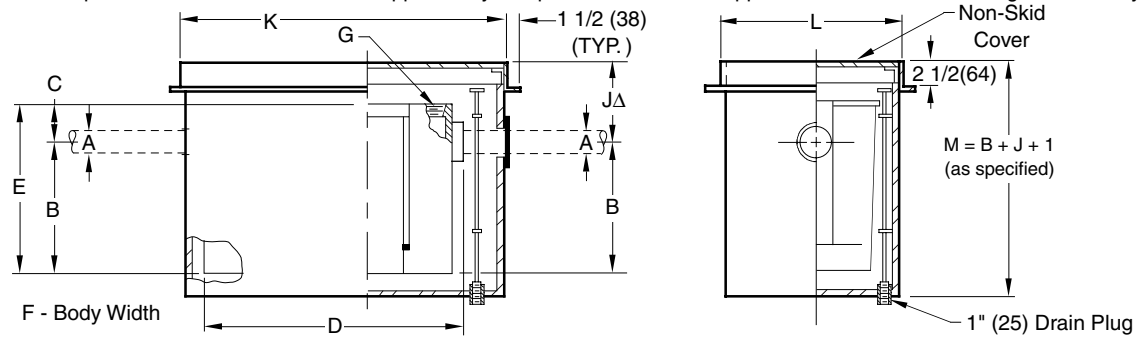

Openings for Adjustable Pipe Depths

Fig No.	GPM Flow Rate	Grease Cap Lbs.	Inlet and Outlet Size	Dimensions						C.O Plug Size	Cradle Dimensions			
				Roughing Dimensions				Body			JΔ	K	L	M (as Specified)
				A*	B	C	D	E	F					
SQ-8-1896-04	4	8	02 (50)	7 3/4 (195)	3 1/4 (83)	16 3/4 (425)	11 (280)	10 (255)	2 (51)	7 (180)	28 3/4 (730)	17 3/4 (450)		
SQ-8-1896-07	7	14	02 (50)	8 1/2 (215)	3 1/2 (89)	19 (485)	12 1/8 (308)	10 3/4 (275)	2 (51)	7 (180)	31 (785)	17 3/4 (450)		
SQ-8-1896-10	10	20	02 (50)	9 1/2 (240)	3 3/4 (95)	21 1/4 (540)	13 3/8 (340)	13 (330)	2 (51)	7 1/2 (190)	33 1/4 (845)	17 3/4 (450)		
SQ-8-1896-15	15	30	02 (50)	12 (305)	3 1/2 (89)	25 (635)	15 1/2 (395)	14 (355)	2 (51)	7 1/2 (190)	37 (940)	21 1/4 (540)		
SQ-8-1896-20	20	40	03 (80)	13 (330)	4 (100)	28 1/2 (725)	17 (430)	15 3/4 (400)	2 (51)	7 1/2 (190)	40 1/2 (1030)	21 1/4 (540)		
SQ-8-1896-25	25	50	03 (80)	15 1/4 (390)	4 1/2 (115)	30 (760)	19 5/8 (498)	16 3/4 (425)	2 (51)	8 1/4 (210)	42 (1065)	26 3/4 (680)		
SQ-8-1896-35	35	70	03 (80)	16 (405)	5 (125)	32 1/2 (825)	21 (535)	18 1/4 (465)	2 (51)	10 1/4 (260)	44 1/2 (1130)	26 3/4 (680)		
SQ-8-1896-50	50	100	03 (80)	17 1/2 (445)	6 3/4 (170)	35 1/2 (900)	24 1/4 (615)	20 3/4 (525)	2 (51)	16 (405)	47 1/2 (1205)	26 3/4 (680)		

Δ When tile top is specified add 1" (25). When terrazzo top is specified add 1 1/4" (32)
 * Larger inlet and outlet sizes available when specified.

NOTE: Dimensions shown in parentheses are in millimeters.

REGULARLY FURNISHED:
 Fabricated Steel Interceptor and
 Fabricated Steel Flanged Cradle with
 Gray Duco Coating Inside and Outside
 and Flow Control Fitting.

VARIATIONS:
 Lift Out Sediment Bucket -B
 Flashing Clamp -C

OPTIONAL MATERIALS:
 Acid Resistant Coating Inside -ARI
 Acid Resistant Coating Outside -ARO
 Acid Resistant Coating Inside and Outside -ARIO
 Aluminum Cover for Cradle -ACC
 Aluminum Cover for Interceptor -AC

SUSPENDED INTERCEPTOR AND/OR CRADLE INSTALLATION REQUIREMENTS:
 When installing an interceptor with or without a cradle, flush in the floor and suspended above another floor or similar open space, proper independent support is essential for safety and functional integrity of the installation. The anchor flange provided is not sufficient for support of the grease interceptor or cradle when suspended in a floor. Supports shall be of sufficient design and strength for the purpose intended. The engineer and/or installer shall be responsible for obtaining the approval of the architect and structural engineer and providing and installing appropriate material. Jay R. Smith Mfg. Co. will not be responsible for installation of the interceptor, cradle or independent support for the interceptor or cradle.

C	12/30/99	Revised verbiage	JJ	McD	WEIGHT POUNDS	VOLUME CUBIC FEET	FIGURE NUMBER SQ-8-1896
B	09/16/98	Update Dwg	CMD				
A	08/14/96	Added Note	CMD				
REV.	DATE	DESCRIPTION	BY	CKD. BY			

WE CAN ASSUME NO RESPONSIBILITY FOR USE OF SUPERSEDED OR VOID DATA